

# Installation Instructions

## Joint System: 233 - A09 (8" to 18" Systems)

**Note:** Verify that the structural gap and blockout dimensions are in conformance with submittal data before beginning installation. If this is a Fire Rated Assembly, the fire barrier must be installed before the Architectural Joint System. Refer to the fire barrier instructions for specific system installation.

**Figure 1 (233-A09 Wall to Corner shown)**

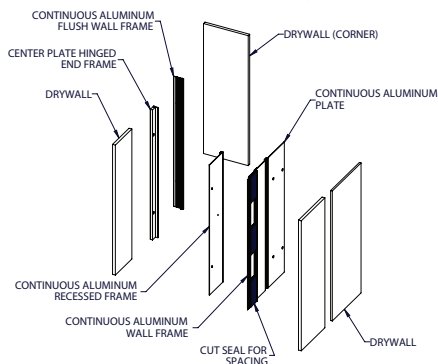

1. Recess 5/8" drywall as per the architectural drawings.

**Figure 1**

2. Cut the aluminum components to the required length. Attach the continuous Aluminum Wall Frame (J1A030-F) to the wall using #8 x 2" flat head screws (JK061) 18" on center.

**Figure 2**

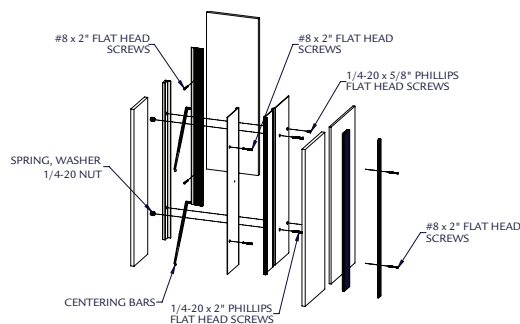

**Figure 2**

3. Attach the Continuous Aluminum Recessed Frame using #8 x 2" flat head screws (JK061) 18" on center.
4. Slide the Center Plate Hinged End Frame (J2E001) into the Continuous Aluminum Flush Wall Frame (J3A200). Fasten this assembly to the wall so the front surface of the Center Plate Hinged End Frame is on the same plane as the front surface of the Continuous Aluminum Recessed Frame.
5. Attach the Continuous Flush Wall Frame to the wall using #8 x 2" flat head screws (JK061) 18" on center.
6. Assemble the continuous aluminum plate and centering bars using 1/4-20 x 2" screws, spring, washers and 1/4-20 nut. Align centering bars parallel to the flush plate.
7. Line up the holes in the continuous aluminum plate with the threaded holes in the Center Plate Hinged End Frame. Fasten the plate to the hinged end frame with 1/4-20 x 5/8" Philips Flat Head Screws (JK037).
8. Tighten the screws to engage the centering bars in the recessed frame.
9. Press the santoprene seal into the frames.

**Figure 3 (233-A09 completed installation)**

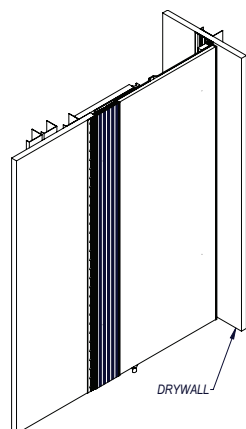

**Figure 3**

10. Feather and finish flanges with joint compound. Attach drywall as needed to complete the installation.

IPC.938/REV.1



### Installation Questions?

Contact our Installation Hotline 866.EZINPRO  
For Sales & Customer Service call 800.222.5556

**INPRO CORPORATION**  
Interior and Exterior Architectural Products