

# 807 Series

A01 - Floor to Floor

A02 - Floor to Wall



Movement Rating  $\pm$  50%

## Product Guide



Thermal



Interior



Fire Rated Option



Vapor Barrier Option

- Designed to accommodate various flooring thicknesses from carpet to VCT
- Overlap design reduces sightline
- Easy to install
- Economical solution for retrofit and surface mount installations
- Mill finish aluminum
- Designed for uneven slab conditions
- Pre-drilled counter-sunk holes for easy installation

Application	System	W		H1		H2		S		B		Movement +/-			
		Joint Width		Frame Height 1		Height 2		Sightline		Blockout		Horizontal		Vertical	
		US	mm	US	mm	US	mm	US	mm	US	mm	US	mm	US	mm
Floor to Floor	J807-A01-050	2"	50	*	*	1/8,3/8"	3,10	2"	50	*	*	1"	25	+1/4" / -1"	+5 / -25
	J807-A01-075	3"	75	*	*	1/8,3/8"	3,10	2"	50	*	*	1 1/2"	38	3/8"/-1 1/2"	+7/-38
	J807-A01-100	4"	100	*	*	1/8,3/8"	3,10	2"	50	*	*	2"	51	+5/8" / -2"	+10 / -51
	J807-A01-150	6"	150	*	*	1/8,3/8"	3,10	2"	50	*	*	3"	76	+7/8" / -2 3/4"	+13 / -71
Floor to Wall	J807-A02-050	2"	50	*	*	1/8,3/8"	3,10	2"	50	*	*	1"	25	+1/4" / -1"	+6 / -25
	J807-A02-075	3"	75	*	*	1/8,3/8"	3,10	2"	50	*	*	1 1/2"	38	3/8"/-1 1/2"	+7/-38
	J807-A02-100	4"	100	*	*	1/8,3/8"	3,10	2"	50	*	*	2"	51	+5/8" / -2"	+10 / -51
	J807-A02-150	6"	150	*	*	1/8,3/8"	3,10	2"	50	*	*	3"	76	+7/8" / -2 3/4"	+13 / -71

IPC.799/REV.5

Inprocorp.com • 800.222.5556 • 262.679.9010  
 World Headquarters S80 W18766 Apollo Drive, Muskego, WI 53150 USA

**JOINTMASTER®**  
 EXPANSION JOINT SYSTEMS  
 A DIVISION OF INPRO®

# 807 Series

## Floor and Wall Systems

807-A01 Floor/Floor  
(2" (51mm) system shown)

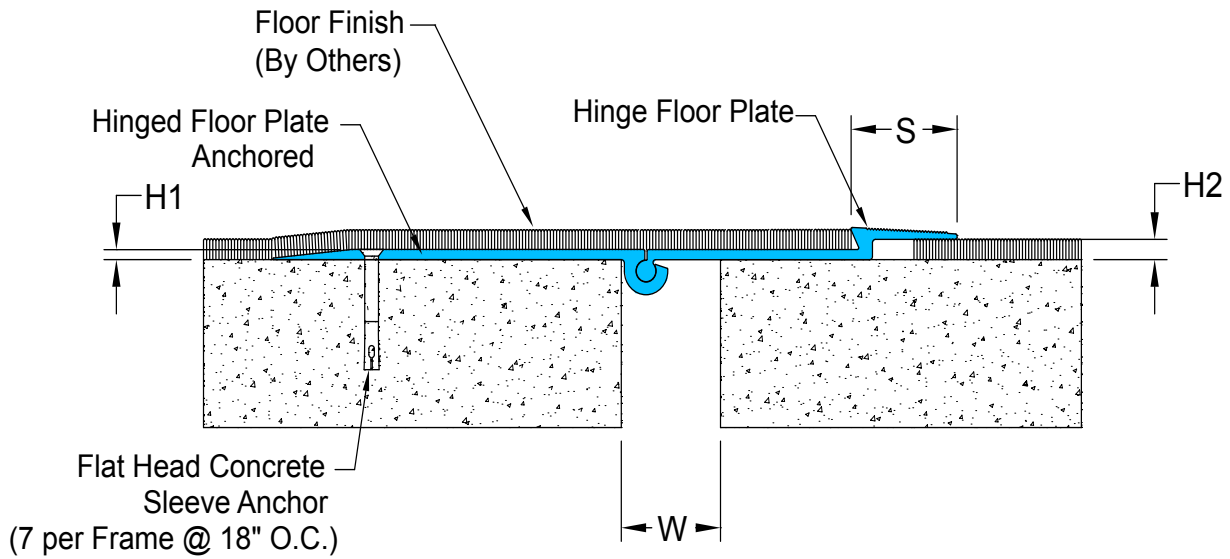

807-A02 Floor/Wall  
(2" (51mm) system shown)

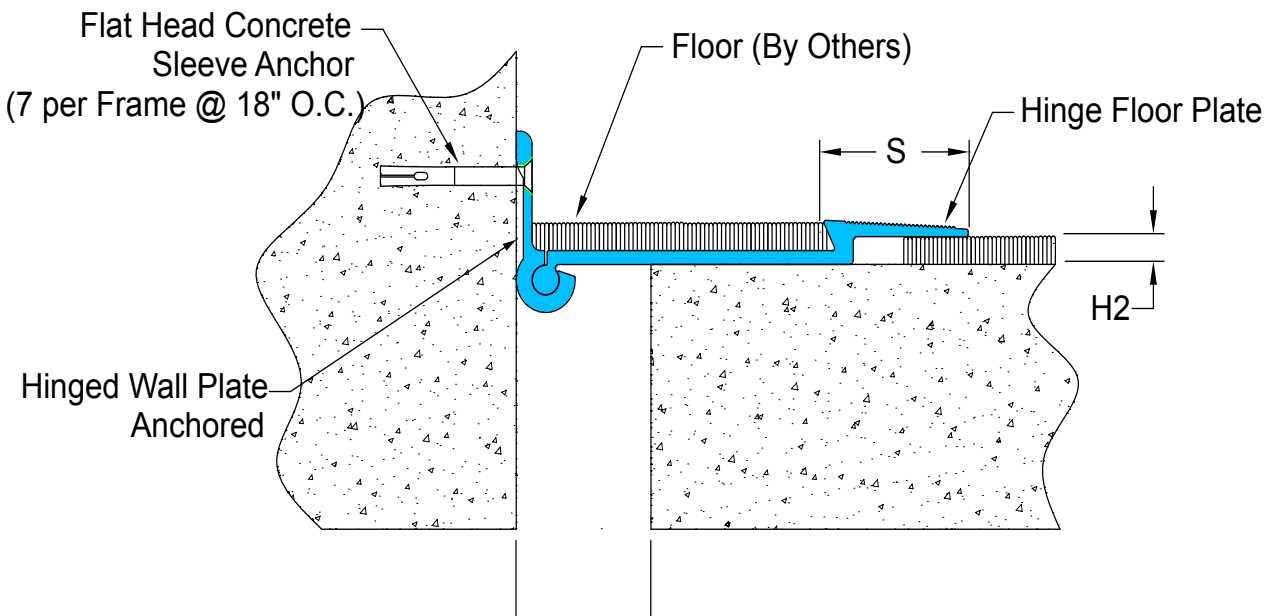

# 807 Series

## Options

807-A01 Floor/Floor With Vapor Barrier  
(2" (51mm) system shown)

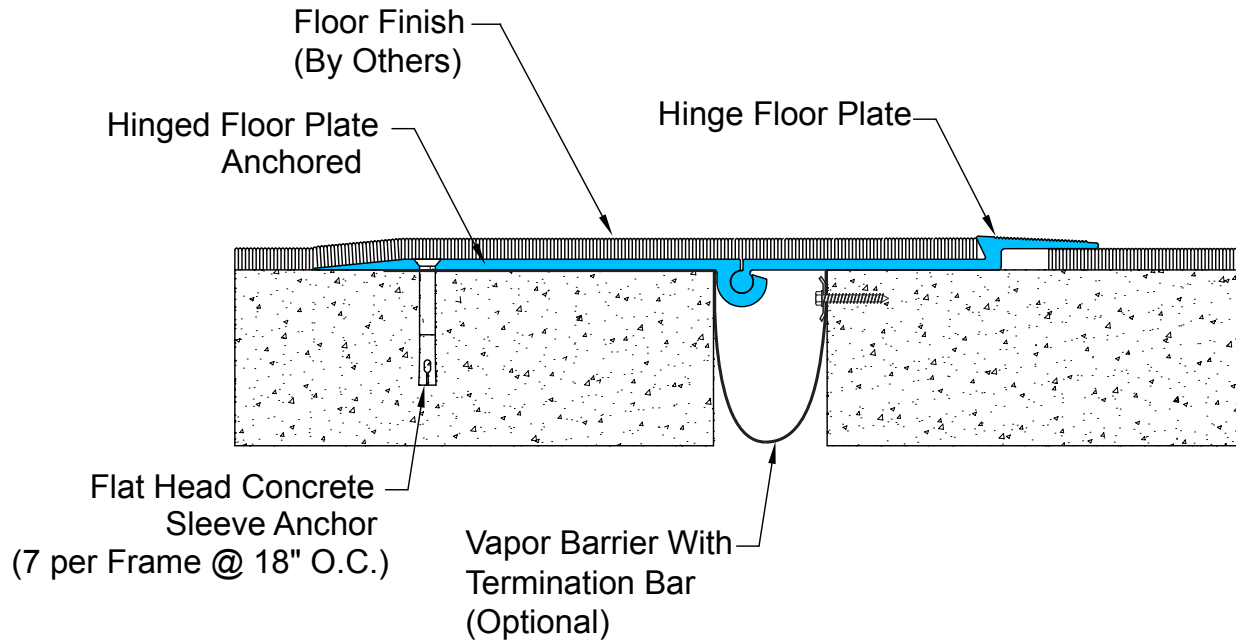

807-A01 Floor/Floor With Fire Barrier  
(2" (51mm) system shown)

