

System	Joint Width		Seal Height		Movement ±			
	US	mm	US	mm	Compression	Expansion		
					US	mm	US	mm
990V2-050 UC	1/2"	13	4"	102	1/8"	3	1/8"	3
990V2-100 UC	1"	25	4"	102	1/4"	6	1/4"	6
990V2-150 UC	1 1/2"	38	4"	102	3/8"	10	3/8"	10
990V2-200 UC	2"	51	4"	102	1/2"	13	1/2"	13
990V2-250 UC	2 1/2"	64	4"	102	5/8"	16	5/8"	16
990V2-300 UC	3"	76	4"	102	3/4"	19	3/4"	19
990V2-350 UC	3 1/2"	89	4"	102	7/8"	22	7/8"	22
990V2-400 UC	4"	102	4"	102	1"	25	1"	25
990V2-450 UC	4 1/2"	114	4"	102	1 1/8"	29	1 1/8"	29

NOTE:  
LENGTH- 6 .5' [1981mm]

**JOINTMASTER**<sup>®</sup>  
EXPANSION JOINT SYSTEMS

DATE: 2-25-16  
SCALE: 1:2  
DOC: CADJM.175/Rev2

APPLICATION-  
WALL/WALL AND WALL/CORNER  
2 HOUR FIRE RATED

**inpro.**

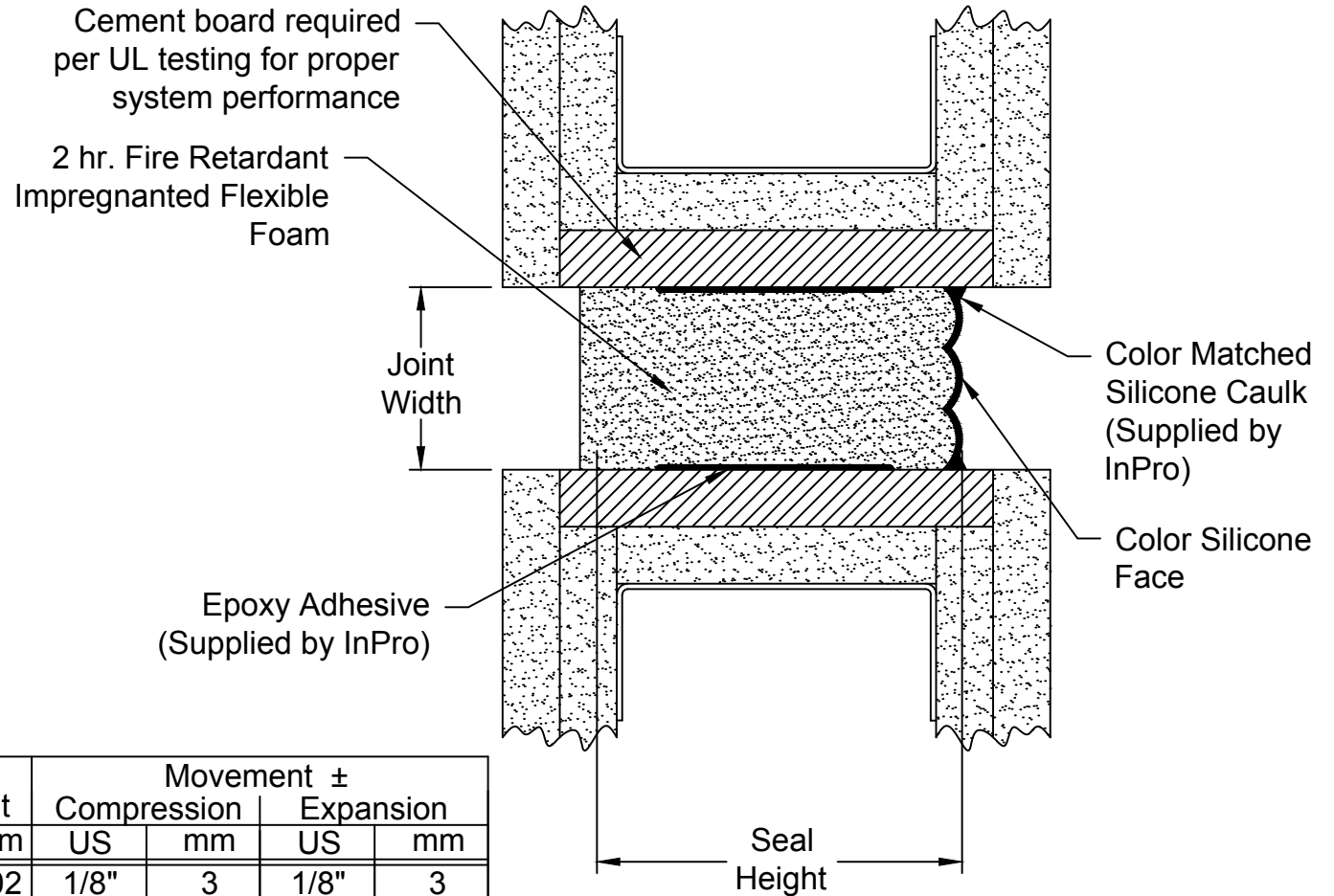

System	Joint Width		Seal Height		Movement ±			
	US	mm	US	mm	Compression US	mm	Expansion US	mm
990V2-050	1/2"	13	4"	102	1/8"	3	1/8"	3
990V2-100	1"	25	4"	102	1/4"	6	1/4"	6
990V2-150	1 1/2"	38	4"	102	3/8"	10	3/8"	10
990V2-200	2"	51	4"	102	1/2"	13	1/2"	13
990V2-250	2 1/2"	64	4"	102	5/8"	16	5/8"	16
990V2-300	3"	76	4"	102	3/4"	19	3/4"	19
990V2-350	3 1/2"	89	4"	102	7/8"	22	7/8"	22
990V2-400	4"	102	4"	102	1"	25	1"	25
990V2-450	4 1/2"	114	4"	102	1 1/8"	29	1 1/8"	29

NOTE:  
LENGTH- 6 .5' [1981mm]

**JOINTMASTER**<sup>®</sup>  
EXPANSION JOINT SYSTEMS

DATE: 2-25-16  
SCALE: 1:2  
DOC: CADJM.175/Rev2

APPLICATION-  
WALL/WALL AND WALL/CORNER  
2 HOUR FIRE RATED

**inpro.**

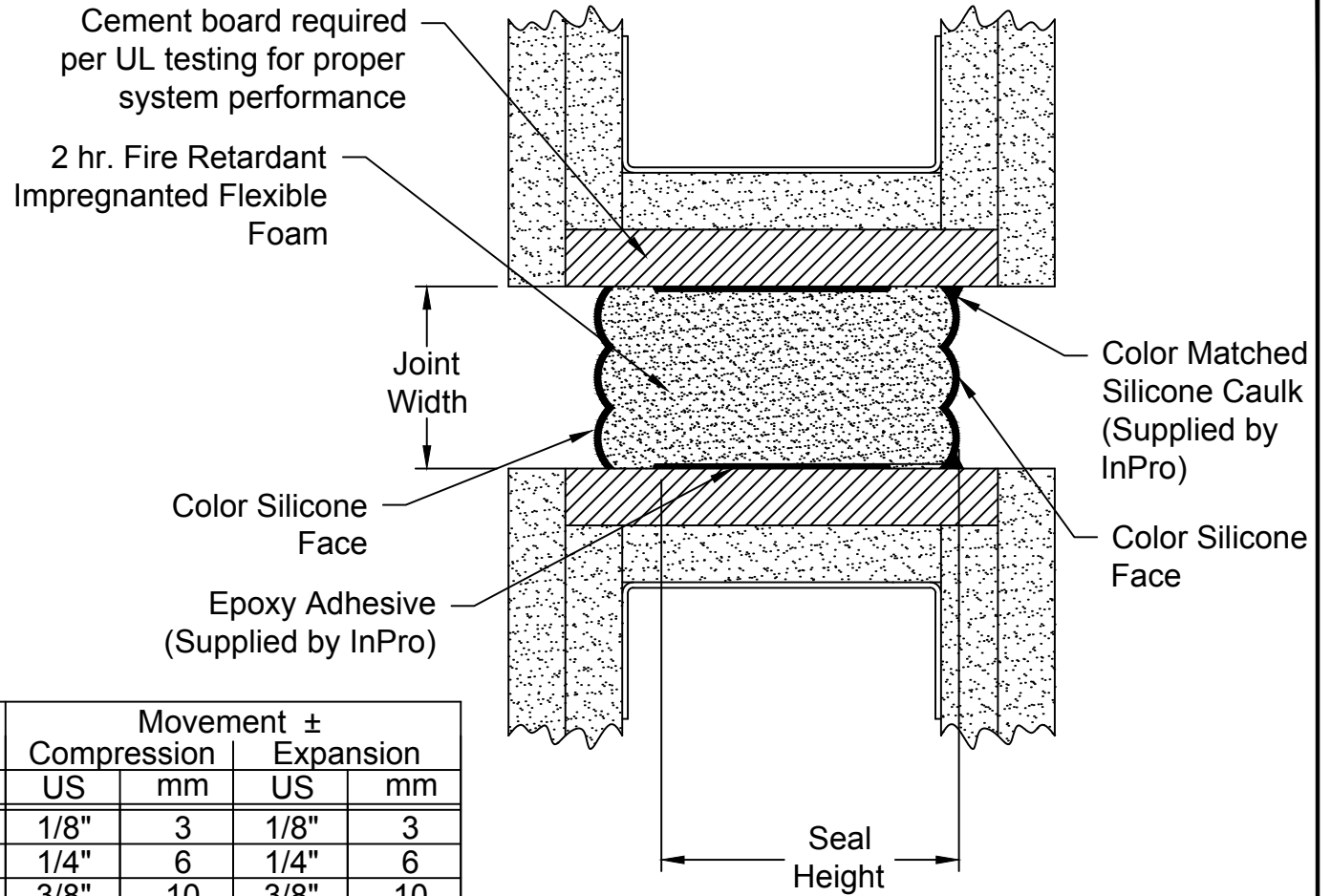

System	Joint Width		Seal Height		Movement ±			
	US	mm	US	mm	Compression		Expansion	
					US	mm	US	mm
990V2-050 DS	1/2"	13	4"	102	1/8"	3	1/8"	3
990V2-100 DS	1"	25	4"	102	1/4"	6	1/4"	6
990V2-150 DS	1 1/2"	38	4"	102	3/8"	10	3/8"	10
990V2-200 DS	2"	51	4"	102	1/2"	13	1/2"	13
990V2-250 DS	2 1/2"	64	4"	102	5/8"	16	5/8"	16
990V2-300 DS	3"	76	4"	102	3/4"	19	3/4"	19
990V2-350 DS	3 1/2"	89	4"	102	7/8"	22	7/8"	22
990V2-400 DS	4"	102	4"	102	1"	25	1"	25
990V2-450 DS	4 1/2"	114	4"	102	1 1/8"	29	1 1/8"	29
990V2-500 DS	5"	127	4"	102	1 1/4"	32	1 1/4"	32
990V2-550 DS	5 1/2"	140	4"	102	1 3/8"	35	1 3/8"	35
990V2-600 DS	6"	152	4"	102	1 1/2"	38	1 1/2"	38

NOTE:  
LENGTH- 6 .5' [1981mm]

**JOINTMASTER**<sup>®</sup>  
EXPANSION JOINT SYSTEMS

DATE: 2-25-16  
SCALE: 1:2  
DOC: CADJM.175/Rev2

APPLICATION-  
WALL/WALL AND WALL/CORNER  
2 HOUR FIRE RATED

**inpro.**